

We just widened the gap between Boston Whaler and every other fishing boat in its class.

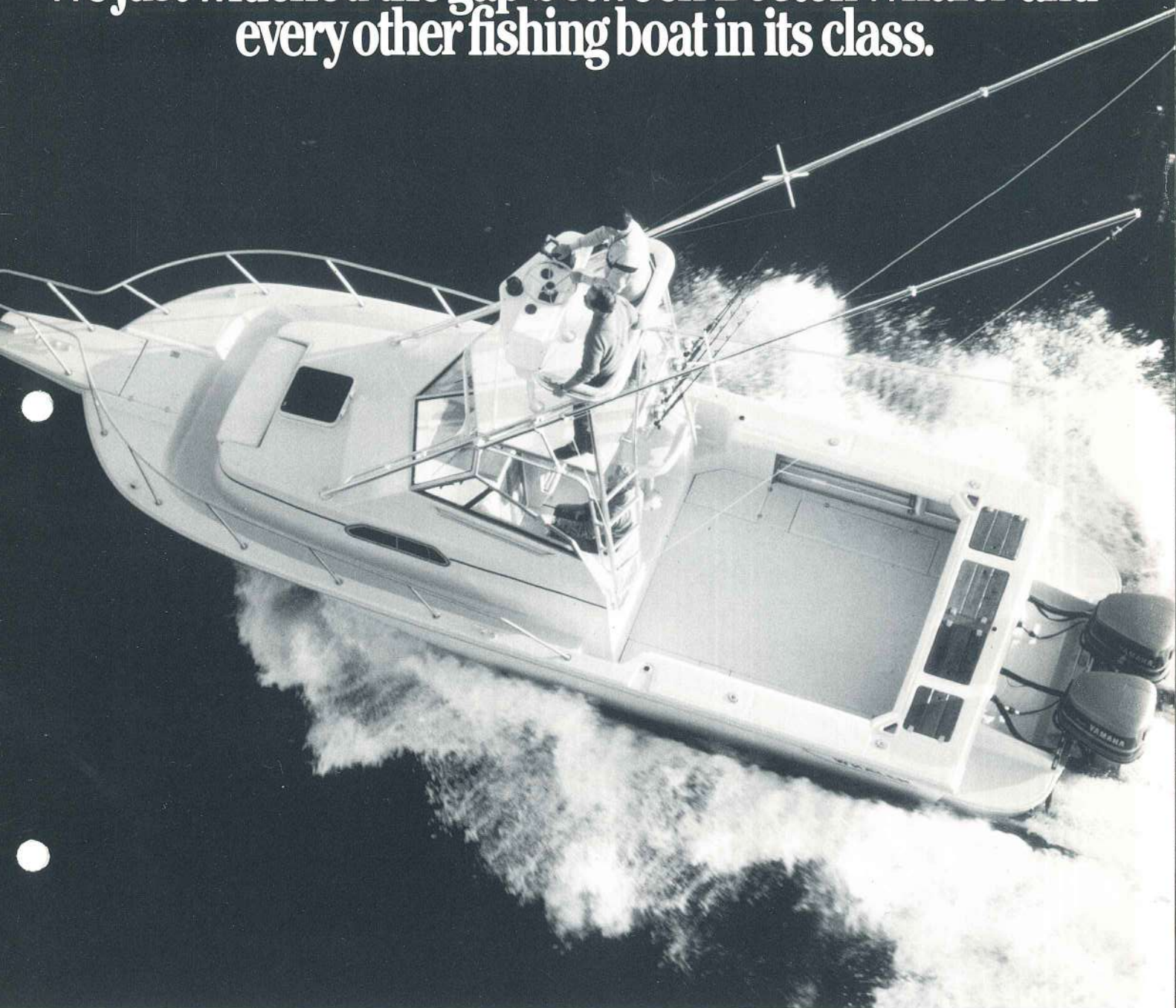

For over 30 years, Whalers have ventured farther, defied nastier weather and logged more offshore miles than other boats in their class. All to the infinite delight of people for whom fishing is less a recreation than an all-out passion.

If you're one of those people, our new Whaler® 25 Walkaround will let your passions run even wilder. With nearly ten feet between the gunnels, obstacles like whitecaps, rollers and angry chop suddenly seem less threatening. And those far-off fishing spots, a lot more inviting.

Once there, you'll have enough wrestling room aft to grapple with

just about anything that swims. And enough deck space about the cabin to follow the wildest of fish around the boat with ease.

As befits the serious offshore sportsman, the Whaler 25

also offers a complete inventory of fish boxes. Baitwells. Insulated coolers. Rod racks. Not to mention the security of our unsinkable foam-filled hull, backed by a ten-year transferrable warranty.

The Whaler 25 Walkaround. It'll widen your perspective of what a great fishing boat should be.



Introducing the Whaler 25 Walkaround.



Key Specifications: LOA 25'3" (27'11" with Whaler Drive™). Beam 9'6". Draft 18". Boat weight 5,500 lbs. Max. weight capacity (persons, motor and gear) 4200 lbs. Swamped capacity 10,000 lbs. Persons capacity 12. Max. horsepower 550. Transom height 25". Sleeps 3. Fuel 250 gal.

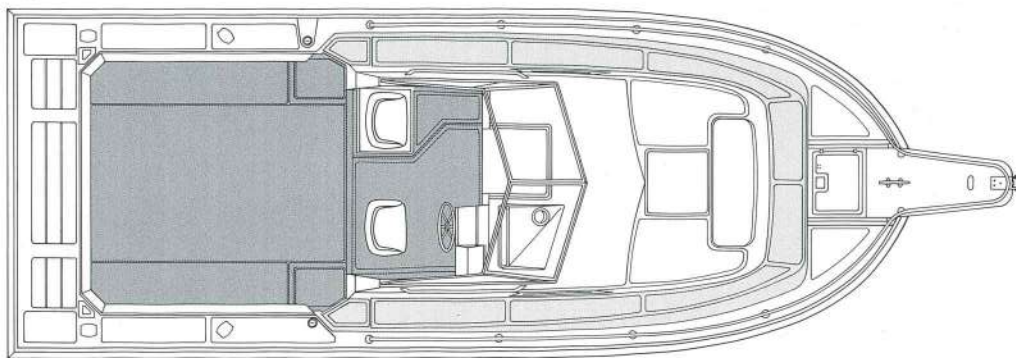

Partial list of hull, deck and cockpit standard features: Bow pulpit with stainless bow rail. Anchor locker and roller. Pedestal chairs w/cushions. Hydraulic steering. Hydraulic trim tabs. Compass. Two automatic bilge pumps. Coaming bolsters. Three insulated fish boxes and two baitwells w/O.B. drain. Two insulated coolers. Horizontal rod racks. Flush mount rod holders (4). Washdown pump w/hose. Self-bailing 50 sq. ft. cockpit.

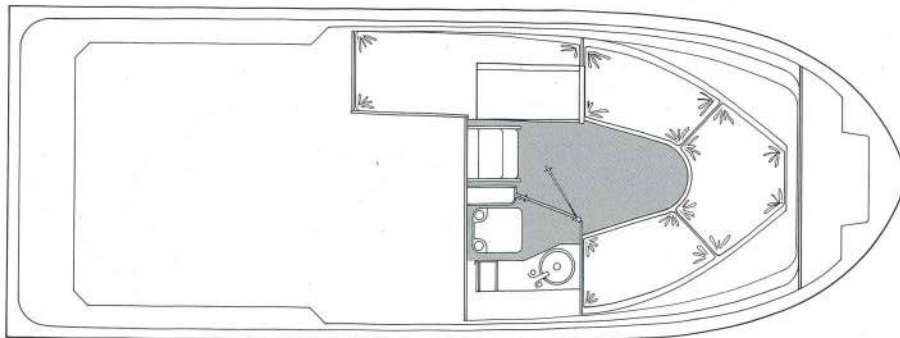

Partial list of cabin standard features: *Cabin:* Lighted V-berth and quarter berth. Under bunk storage. Dinette. Cushions. Fold-down galley counter. Rod storage. *Head:* Fully enclosed and lighted. Sink w/pressure system. 15-gallon water tank. Head w/deck pump out/overboard. Vanity w/overhead cabinet.

See your Boston Whaler® dealer for a complete list of standard and optional equipment.



A CML Company

1149 Hingham Street, Rockland, MA 02370, (617) 871-1400 Telex No. 940-0708

Call 1-800-WHALER-9 for product literature on our complete line or find your Boston Whaler dealer under "Boats" in the Yellow Pages.

Boston Whaler®, Whaler® and Whaler Drive™ are trademarks and registered trademarks of Boston Whaler, Incorporated.